

施工说明书 Instructions for construction

安装产品前请仔细阅读本施工说明书，并保留备用。
Before product installation, read these instructions for
construction carefully and retain it for future reference.

TOTO

TOTO

OG4021Y(D)
2021.10

目录

目 录	
目 录	1
明细单	2
使用条件与施工上的注意	3
施工上的注意	4
施工上的注意与保养	5
安装完成图	6-8
水嘴的安装	9-13
生产厂家与销售商	14

明细单



明细单	
水嘴主体部	1套
温度调节手柄	1套
开闭切替手柄	1套
(※单恒温产品只有温度调节手柄)	
装饰板	1套
衬板	1个
螺钉	4个
六角扳手	1个
施工说明书	1本
使用说明书	1本
使用此明细单的产品包括：	
TBV01406* 单柄恒温淋浴（浴缸）暗装普通水压水嘴面板	
TBV02401* 单柄恒温淋浴（浴缸）暗装普通水压水嘴面板	
TBV01407* 双柄恒温淋浴暗装普通水压水嘴面板（单开闭）	
TBV02403* 双柄恒温淋浴暗装普通水压水嘴面板（单开闭）	
TBV01408* 双柄恒温淋浴暗装普通水压水嘴面板（开闭切替）	
TBV02404* 双柄恒温淋浴暗装普通水压水嘴面板（开闭切替）	

使用条件与施工上的注意

使用条件

1. 供冷水*供热水压强
最低压强..... 0.05MPa（流动压）
最高压强..... 1.0MPa（静压）
推荐使用压强..... 0.1-0.5MPa（流动压）
超过0.5MPa要加装减压阀。
检测压强..... 1.6MPa（静压）
 2. 冷水温度4℃~29℃、热水温度45℃~85℃，建议正常使用热水温度为50℃~75℃，供热水请勿使用蒸汽。
 3. 使用环境温度0℃以上。如果低于0℃，水嘴会出现变形、冻裂等现象。
 4. 为防止花洒内部损坏，花洒侧吐水温度不得超过60℃，建议使用温度45℃以下。
 5. 长时间不使用时，可能导致水嘴内部及外部锈蚀不能使用等现象。
 6. 如果您需要废弃本产品，请勿将其作为一般生活垃圾处理，请依照法规经由独立的回收体系进行合适的处理，恢复和回收。
 7. 本说明书中的产品具有清洗功能。
- ※为了达到最好的安装与使用效果，水嘴本体推荐与「TOTO」其它系列产品配套使用。

施工上的注意

-  **警告** 表示如果无视此标志而误操作时，有可能造成人员重伤或死亡。
-  **注意** 表示如果无视此标志而误操作时，有可能造成人身伤害或财产损失。

施工上的注意

警告

1. 水嘴的供热水一侧处于高温状态，请勿使皮肤直接接触五金配件表面，否则可能会烫伤。
2. 请勿配反冷*热水配管，否则可能会烫伤。
3. 供热水请勿使用蒸汽，否则可能会烫伤。
4. 使用前，要用手测试水温后再使用，否则可能会烫伤。
5. 慢慢地旋转温度调节手柄，若急速地转动温度调节手柄，温度会骤然上升或下降。
6. 温度调节手柄上的安全按钮与装饰板上“40”的标记居中对齐时，出水温度为40℃；温度调节手柄逆时针旋转（不按安全按钮）至转不动时，出水温度为42℃左右；温度调节手柄按动安全按钮后，继续逆时针旋到旋不动时，出水温度为45℃左右。
使用了热水后必须将温度调节手柄到“40”以下，以免再使用时又喷出热水。
7. 产品不可在0℃以下的环境使用，否则会因结冰，阀芯失灵导致烫伤。一旦发生结冰，要确认温度调节手柄在刻度“40”时的吐水温度。结冰会使设定的温度发生偏差，有烫伤的危险。

注意

1. 由于温控阀芯是较精密的部件，请勿擅自分解，否则可能会造成漏水等不良。
2. 请勿撞击本产品，否则可能会造成故障、漏水。
3. 随着产品式样的不断更新，实物存在与图示不符的情况，但基本安装、使用原理相同。
4. 由于出厂前进行通水检查，故水嘴内可能有残留水，并非产品有问题。
5. 在可能结冰的场所使用时，要切实做好防冻措施。
因结冰，零件破损，有可能导致漏水，造成财产损失。因结冰而造成的破损即使在保修期内也是有偿修理。请不要让产品的环境温度低于0℃。

施工上的注意与保养

防冻措施

在可能结冰的场所使用时，要切实做好防冻措施。

1. 产品结冰的话零件损坏，成为漏水的原因。
2. 因结冰造成的零件破损即使在保修期也是有偿修理。
3. 施工完了后或长时间不使用时，要有预防突然降温的准备，要对产品进行结冰预防。
4. 因为有结冰的危险，请不要让产品周围的温度在0℃以下。

保养

为长期保持产品的美观，请用户按以下方法维护保养。

1. 经常用软布擦拭，间或用软布蘸水擦拭。
2. 当有污垢且比较明显时，请用中性洗涤剂擦拭后充分进行水洗。

安装完成图

TBV02401* 单柄恒温淋浴（浴缸）暗装普通水压水嘴面板与「TOTO」的其它产品搭配示意图

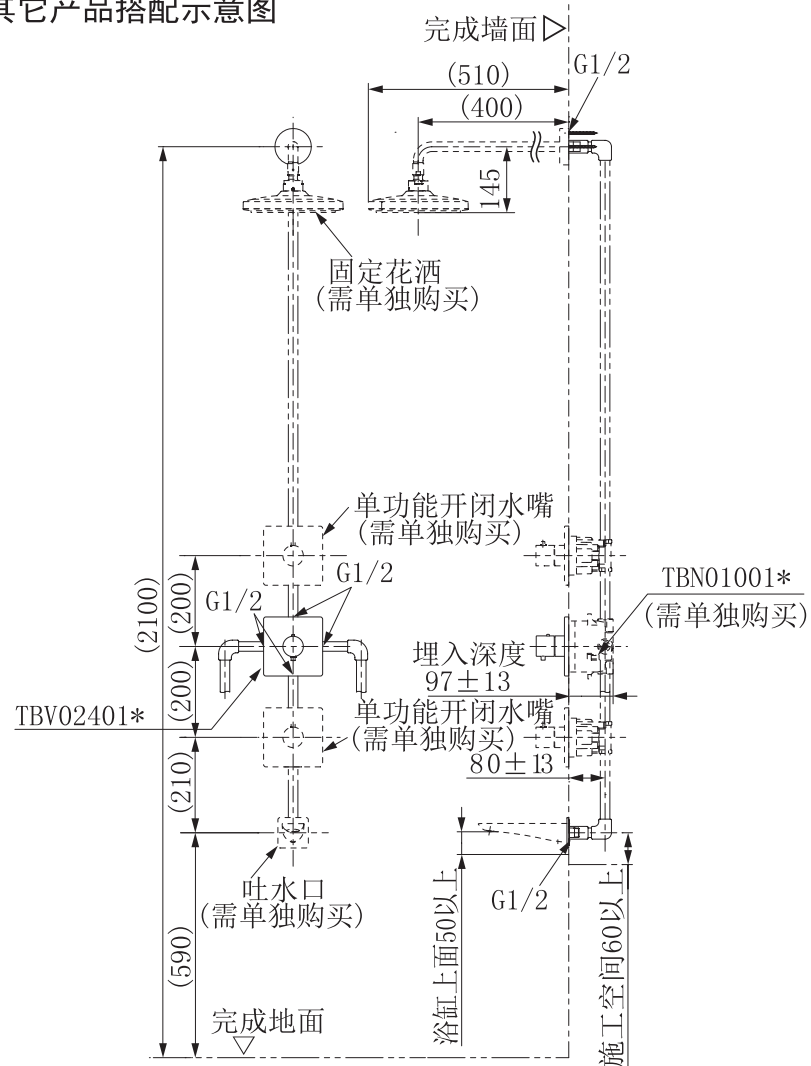

※注：上記尺寸单位为mm，（）内尺寸为参考尺寸。

※注：此产品必须与TBN01001*配套使用。

※TBV01406*与「TOTO」的其他产品配合示意图同TBV02401*，区别：装饰板形状不同。

安装完成图

TBV02403* 双柄恒温淋浴暗装普通水压水嘴面板(单开闭)
与「TOTO」的其它产品搭配示意图

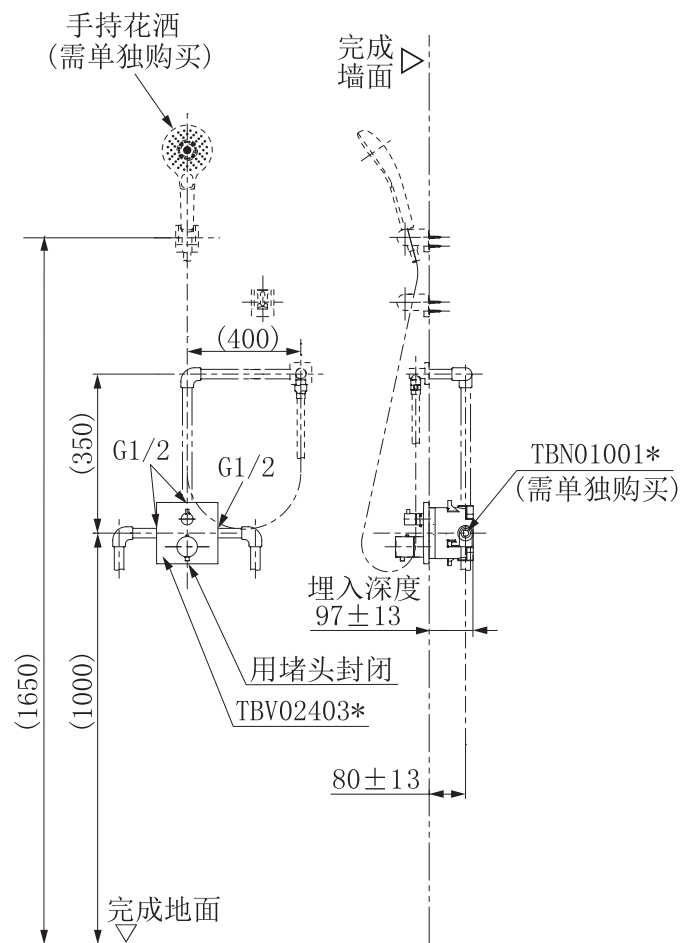

※注：上記尺寸单位为mm，（）内尺寸为参考尺寸。

※注：此产品必须与TBN01001*配套使用。

※TBV01407*与「TOTO」的其他产品配合示意图同TBV02403*，
区别：装饰板形状不同。

安装完成图

TBV02404* 双柄恒温淋浴暗装普通水压水嘴面板(开闭切替)
与「TOTO」的其它产品搭配示意图

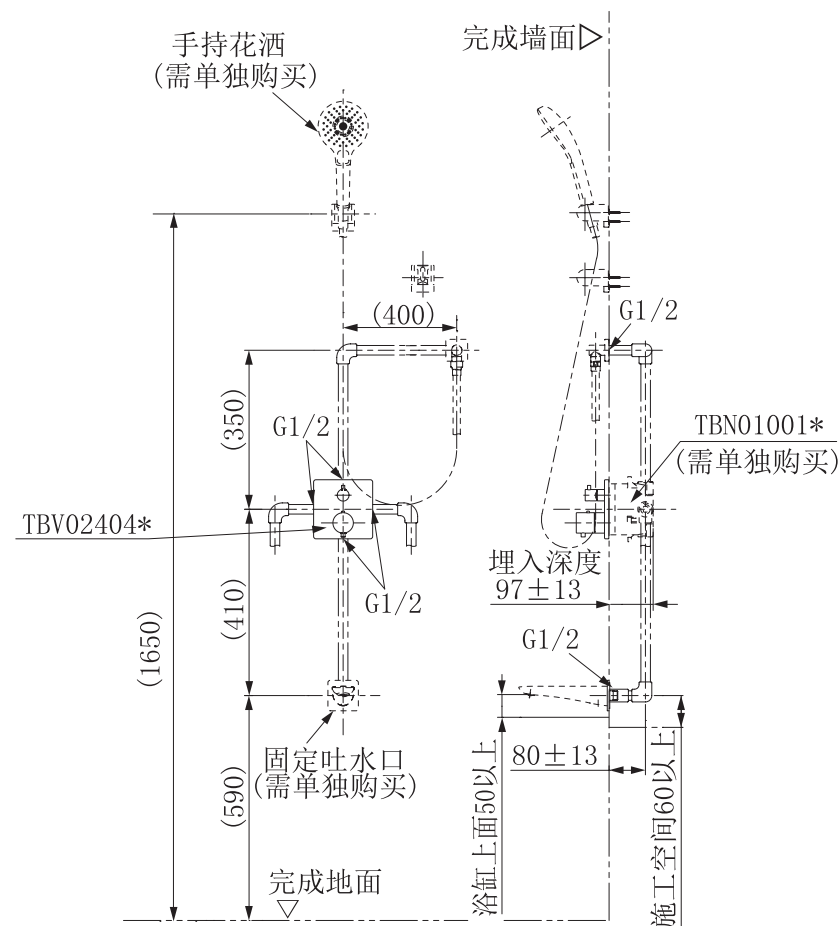

※注：上記尺寸单位为mm，（）内尺寸为参考尺寸。

※注：此产品必须与TBN01001*配套使用。

※TBV01408*与「TOTO」的其他产品配合示意图同TBV02404*，
区别：装饰板形状不同。

水嘴的安装

恒温水嘴

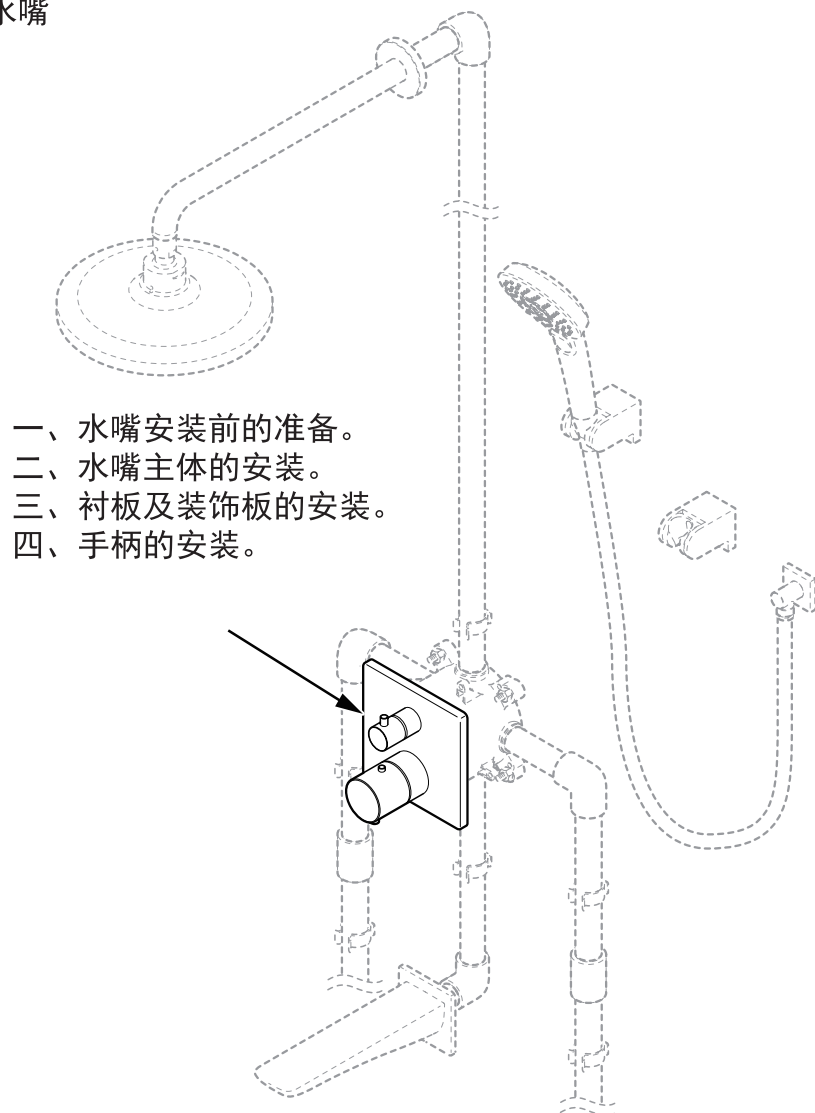

⚠注意:

TBV02404*为例进行施工说明。不同示例产品的安装原理基本相同。

水嘴的安装

安装前准备的工具

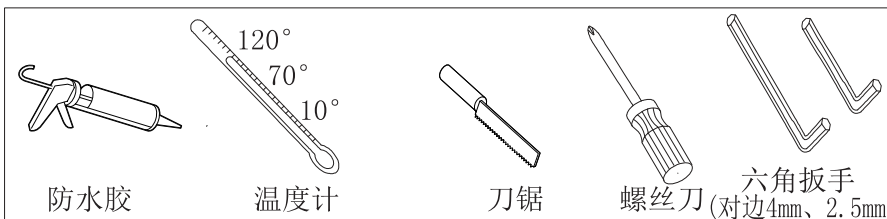

安装前确认

■仔细阅读安装说明书并按照说明书的安装要领来进行安装。

一、水嘴安装前的准备

1. 使用刀锯将埋入盒子凸出于墙面的部分进行切除，需要保证外壳凸起边缘与墙面在2mm以内。

注意

- 埋入盒子外壳切割时要注意切边整齐。(边缘也不能凹陷于墙面以内)
- 树脂保护盖切割时可能被划伤，不影响整个产品的使用。

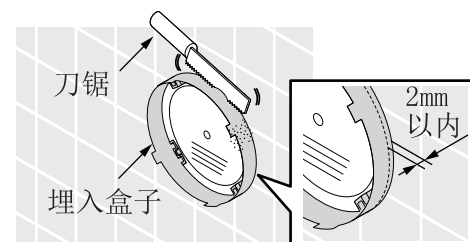

2. 在埋入盒子与墙面的缝隙中均匀涂上防水胶，胶面不能凸出墙面。
3. 取下保护盖，再用六角扳手拆下冲洗盖。

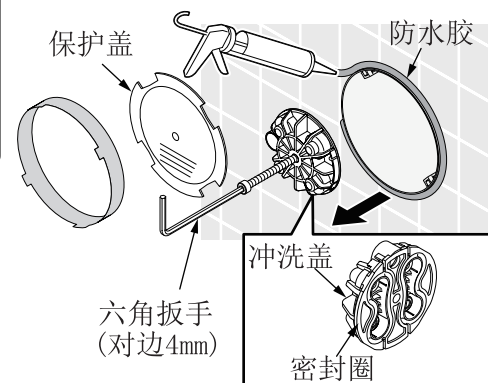

水嘴的安装

二、水嘴主体的安装

- 1、取出水嘴主体部，取下保护盖。
- 2、注意O型圈不能脱落。
- 3、水嘴主体上的“UP”向上方向安装，用六角扳手紧固螺钉固定水嘴。

注意

- 取下保护盖时注意螺钉不要掉落丢失。
- 注意O型圈不能脱落。
- 水嘴主体的固定螺钉请用产品包装内的六角扳手紧固。
- 水嘴主体不能上下颠倒安装。

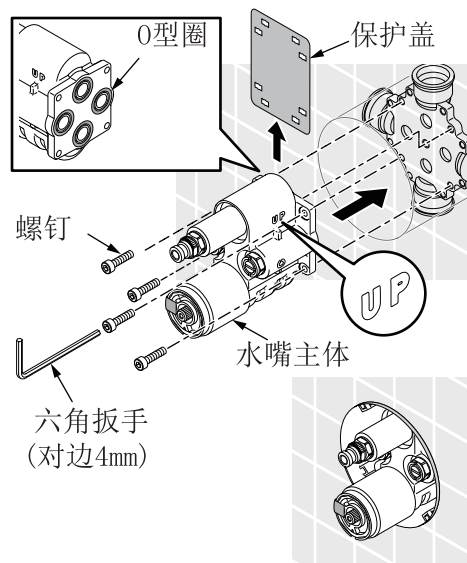

三、衬板及装饰板的安装

- 1、按照衬板上“UP”指示向上状态，套入水嘴主体上。
- 2、用螺丝刀将螺钉紧固于衬板上。

注意

- 安装衬板前，要做耐压检查及确认冷热水止水阀是否完全打开。
- 衬板方向不能上下颠倒安装。因排水口在下面。
- 衬板上不要使用防水胶，因为衬板上有发泡密封胶条及下方有排水口。
- 螺钉紧固时必须压实衬板，衬板与墙面没有缝隙。
- 螺钉需要手动旋紧，不可使电动板手紧固。

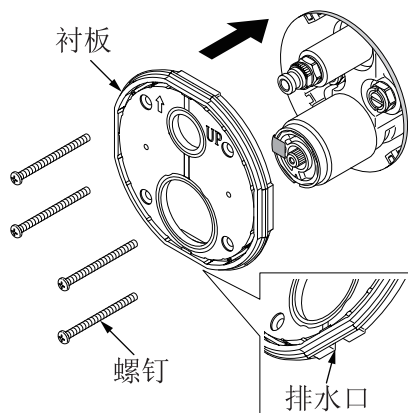

水嘴的安装

- 3、将装饰板的排水口朝下，穿过阀芯套盖套在衬板上。
- 4、装饰板与墙面保持在1mm以内。

注意

- 装饰板安装时，注意不要划伤阀芯套。
- 装饰板周围不可涂防水胶。因为面板下有排水口。

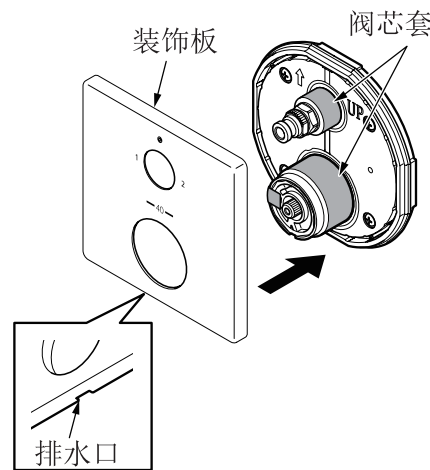

四、手柄的安装

a. 开闭切替手柄的安装

- 1、手柄杆向上插入接手后，再用六角扳手（对边2.5mm）紧固螺钉，固定手柄。

注意

- 手柄杆要与装饰板标示位置居中对齐。
- 出厂时阀芯为关闭状态。

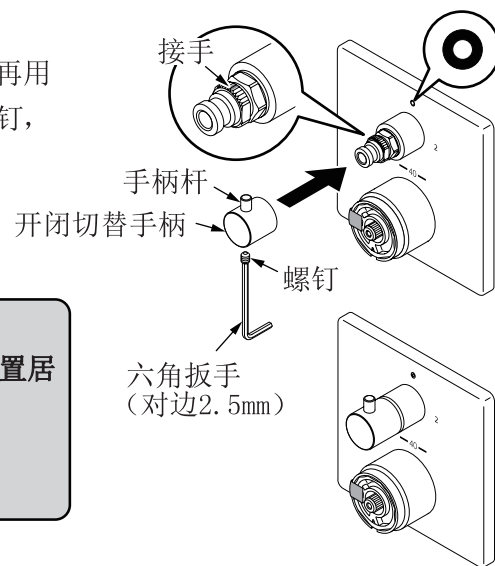

水嘴的安装

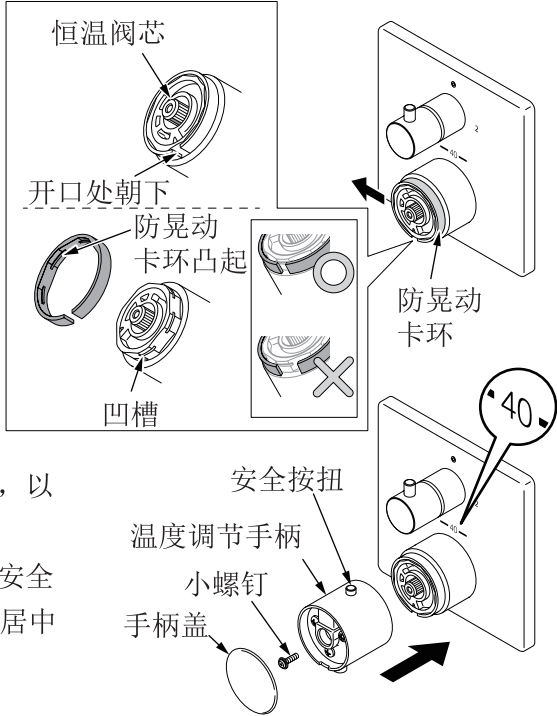

b. 温度调节手柄的安装

- 1、确认防晃动卡环未脱落，以及开口处朝下。
- 2、将手柄套入阀芯轴上，安全按钮与面板上的“40”标记居中对齐。
- 3、用螺丝刀将螺钉紧固。
- 4、盖上手柄盖。

注意

- 水嘴在出厂时已经将出水温度设定40℃。
- 防晃动卡环凸起与螺母凹槽相互压合。
- 防晃动卡环开口向下。

生产厂家与销售商

执行标准：QB/T 2806-2017

产品型号：见包装箱上的标签

产品名称：见包装箱上的标签

生产日期：见包装箱上的标签

组装工厂：东陶（大连）有限公司

电 话：（0411）87624383

厂 址：大连经济技术开发区东北二街17号

东陶（中国）有限公司

全国售后服务电话：800-820-9787（固定电话）
400-820-9787（手机用户）

销售商：东陶（中国）有限公司

地 址：北京市朝阳区光华路1号 北京嘉里中心北楼1915室

网 址：www.toto.com.cn

Contents

Contents

Contents.....	1
Detailed list	2
Use condition and attentions in.....	
construction.....	3
Attentions in construction.....	4
Attentions in construction and maintenance.....	5
Installation completion figure.....	6–8
Faucets installation.....	9–13

Detailed list

Detailed List

Main body of faucets.....	1 set
Temperature-adjusting handle.....	1 set
Open and close switching handle	1 set
(※ Single thermostat product only has a temperature-adjusting handle).	
Decorating plate.....	1 set
Lining plate	1 piece
Screw	4 pieces
Hex wrench.....	1 piece
Instructions for construction.....	1 copy
Instructions for operation.....	1 copy

The products using this detailed list include:

TVB01406* "G Shower" Concealed Thermostat Valve
(Standard Type)

TBV02401* "G Shower" Concealed Thermostat Valve
(Standard Type)

TVB01407* "G Shower" Concealed Thermostat and Volume
Control Valve(Standard Type)

TBV02403* "G Shower" Concealed Thermostat and Volume
Control Valve(Standard Type)

TVB01408* "G Shower" Concealed Thermostat and 2way
Diverter Valve with Shut Off (Standard Type)

TBV02404* "G Shower" Concealed Thermostat and 2way
Diverter Valve with Shut Off (Standard Type)

Use condition and attentions in construction

Use condition

1. Cold water supply*hot water supply pressure
Minimum pressure 0.05MPa (flow pressure)
Maximum pressure 1.0MPa (static pressure)
Recommended service pressure.....0.1–0.5MPa (flow pressure)
It is required to provide a pressure-reducing valve when exceeding 0.5MPa.
Testing pressure.....1.6MPa (static pressure)
2. The cold water temperature is 4°C ~ 29°C and the hot water temperature is 45°C ~ 85°C. It is suggested that the normal temperature of hot water is 50°C ~ 75°C. Do not use steam to supply hot water.
3. The ambient temperature for use is above 0°C. If the ambient temperature is lower than 0°C, the faucets will deform and crack from freezing.
4. To prevent internal sprinkler damage, the water outlet temperature on the sprinkler side shall not exceed 60°C. It is suggested to use a temperature below 45°C.
5. Being out of use for a long time may result in internal and external rust to the faucets and being unable to be used.
6. If you want to scrap this product, do not treat it as you do for general household garbage. Please follow relevant statutes to have it treated, recovered and collected appropriately by an independent recovery system.
7. The product in these instructions has a cleaning function.

※ To attain the best installation and operation effect, it is recommended that the faucet should be used with the handheld series shower from TOTO.

Attentions in construction



Warning: it means that ignoring this mark and misoperation may cause serious personal injury and death.



Attention: it means that ignoring this mark and misoperation may cause personal injury or property loss.

Attentions in construction

⚠ Warning

1. The hot water supply side of the faucets is in a condition of high temperature. Do not allow skin to contact with the hardware surface directly. Otherwise, scalding may occur.
2. Do not reverse the cold*hot water pipes. Otherwise scalding may occur.
3. Do not use steam to supply hot water. Otherwise, scalding may occur.
4. Test the water temperature before using by hand. Otherwise, scalding may occur.
5. Rotate the temperature-adjusting handle slowly. If rotating the temperature-adjusting handle rapidly, the temperature will rise and fall sharply.
6. When the safety button on the temperature-adjusting handle is aligned with the “40” marking on the decorating plate in the center, the water outlet temperature is 40°C; when the temperature-adjusting handle is turned anticlockwise (without depressing the safety button) until it cannot be turned any longer, the water outlet temperature is about 42°C; After pressing the safety button of the temperature-adjusting handle, continue to rotate anticlockwise until no rotation can be made any longer. The water outlet temperature is about 45°C.
After using hot water, it is imperative for the temperature-adjusting handle to be below “40” to avoid hot water spraying out when use again.
7. The product shouldn't be used in an environment below 0°C, otherwise valve core failure may be caused due to icing and you may get burned. In case of icing, please confirm the spouting water temperature when the temperature adjusting handle is at “40”. Icing will cause deviations in the set temperature, which may result in burns.

⚠ Attentions

1. As the ceramic cartridge is a precise component, do not dismantle it without authorization. Otherwise, such poor conditions as water leakage, etc. may be caused.
2. Do not impact the product. Otherwise, failure, water leakage may occur.
3. With the product design being updated constantly, the physical object may not coincide with the figure. However, the basic principle for installation, use is the same.
4. As a water supply inspection is made before leaving factory, there may be water remaining in the faucets and this is not the problem of the product.
5. When using in places where icing may occur, anti-freezing measures must be taken. The parts will be damaged due to icing, which may cause water leakage and property loss. Damages caused by icing are repaired for a fee even during the warranty period. Please ensure that the ambient temperature of the product is always above 0°C.

Attentions in construction and maintenance

Anti-freezing measures

When using in places where icing may occur, anti-freezing measures must be taken.

1. The parts will be damaged due to icing, which may cause water leakage.
2. Damaged parts caused by icing are repaired for a fee even during the warranty period.
3. After the construction is completed or when it is not used for a long time, prepare to prevent sudden drop of temperature and prevent the product from icing.
4. Because of the risk of icing, please ensure that the ambient temperature of the product is always above 0°C.

Maintenance

To maintain a beautiful appearance of the product, the user is requested to conduct maintenance and care in the following method.

1. Wipe with a piece of soft cloth frequently and use a piece of soft cloth dipped in water to wipe from time to time.
2. When dirt exists obviously, please use water to wash sufficiently after wiping with a neutral detergent.

Installation completion figure

Schematic diagram for TBV02401* "G Shower" Concealed Thermostat Valve (Standard Type) mating with other products from TOTO

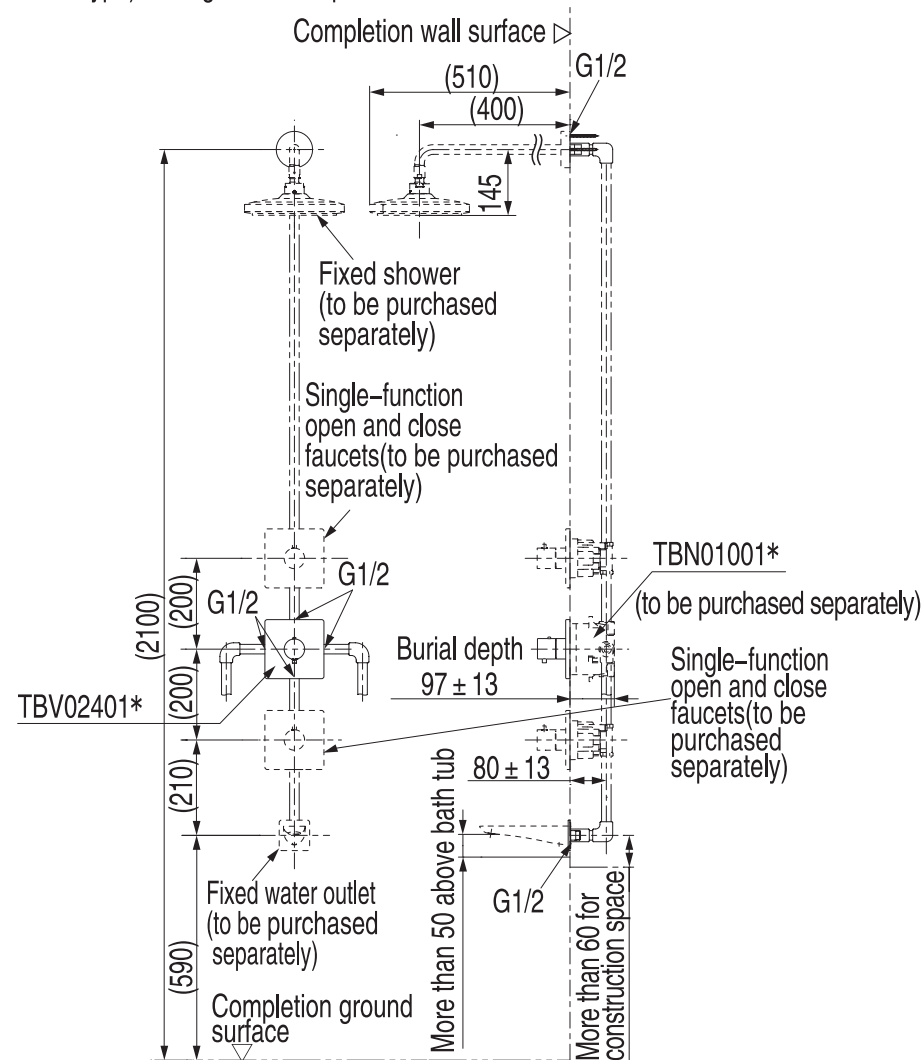

- ※ The unit of the above dimensions is mm. The dimensions in () are reference ones.
- ※ This product must be used with TBN01001*.
- ※ The schematic diagram for TBV01406* mating with other products from TOTO is the same as that for TBV02401*. Difference: The decorating plate shape is different.

Installation completion figure

Schematic diagram for TBV02403* "G Shower" Concealed Thermostat and Volume Control Valve(Standard Type) mating with other products from TOTO

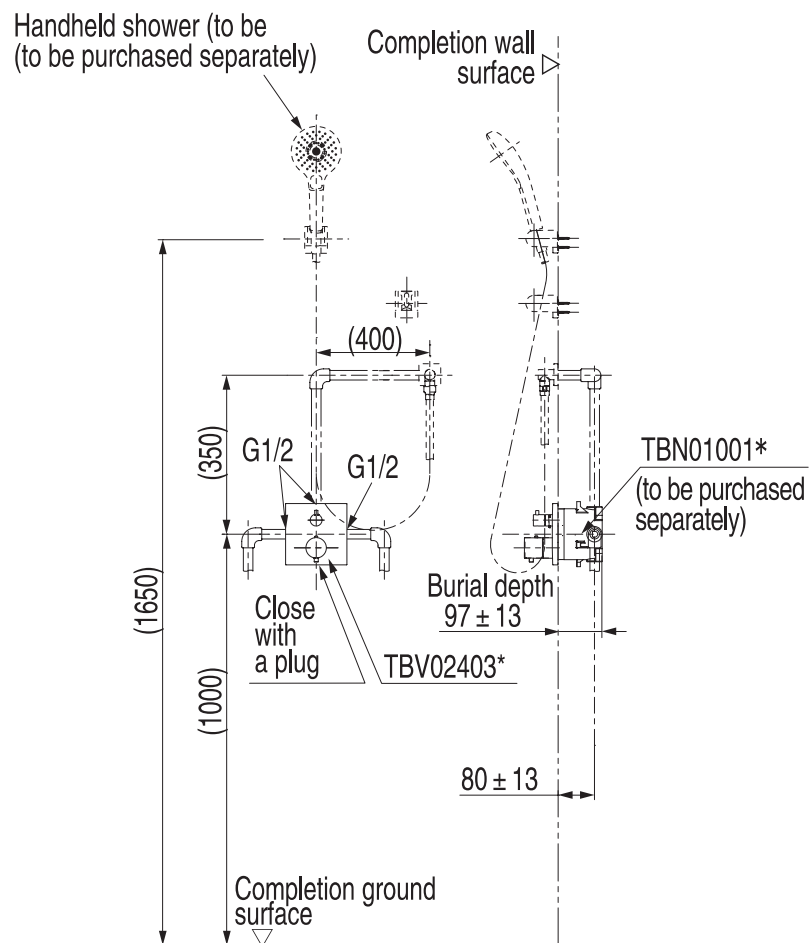

- ※ The unit of the above dimensions is mm. The dimensions in () are reference ones.
- ※ This product must be used with TBN01001*.
- ※ The schematic diagram for TBV01407* mating with other products from TOTO is the same as that for TBV02403*. Difference: The decorating plate shape is different.

Installation completion figure

Schematic diagram for TBV02404* "G Shower" Concealed Thermostat and 2way Diverter Valve with Shut Off (Standard Type)mating with other products from TOTO

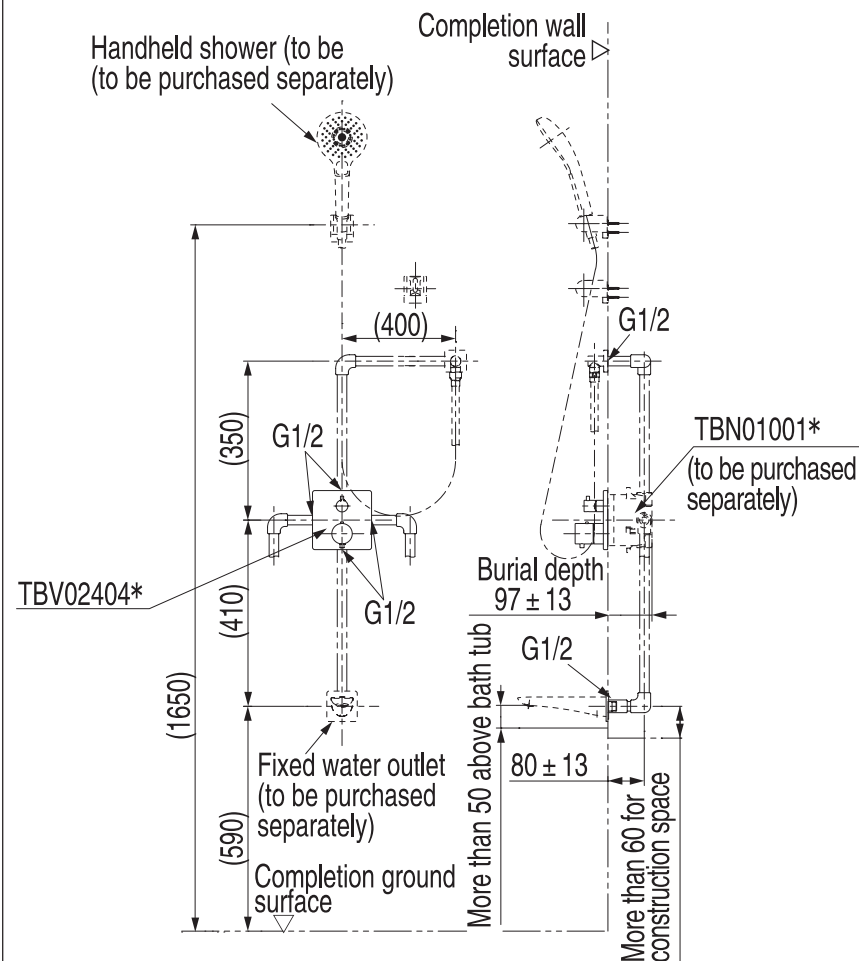

- ※ The unit of the above dimensions is mm. The dimensions in () are reference ones.
- ※ This product must be used with TBN01001*.
- ※ The schematic diagram for TBV01408* mating with other products from TOTO is the same as that for TBV02404*. Difference: The decorating plate shape is different.

Faucets installation

Thermostat faucets

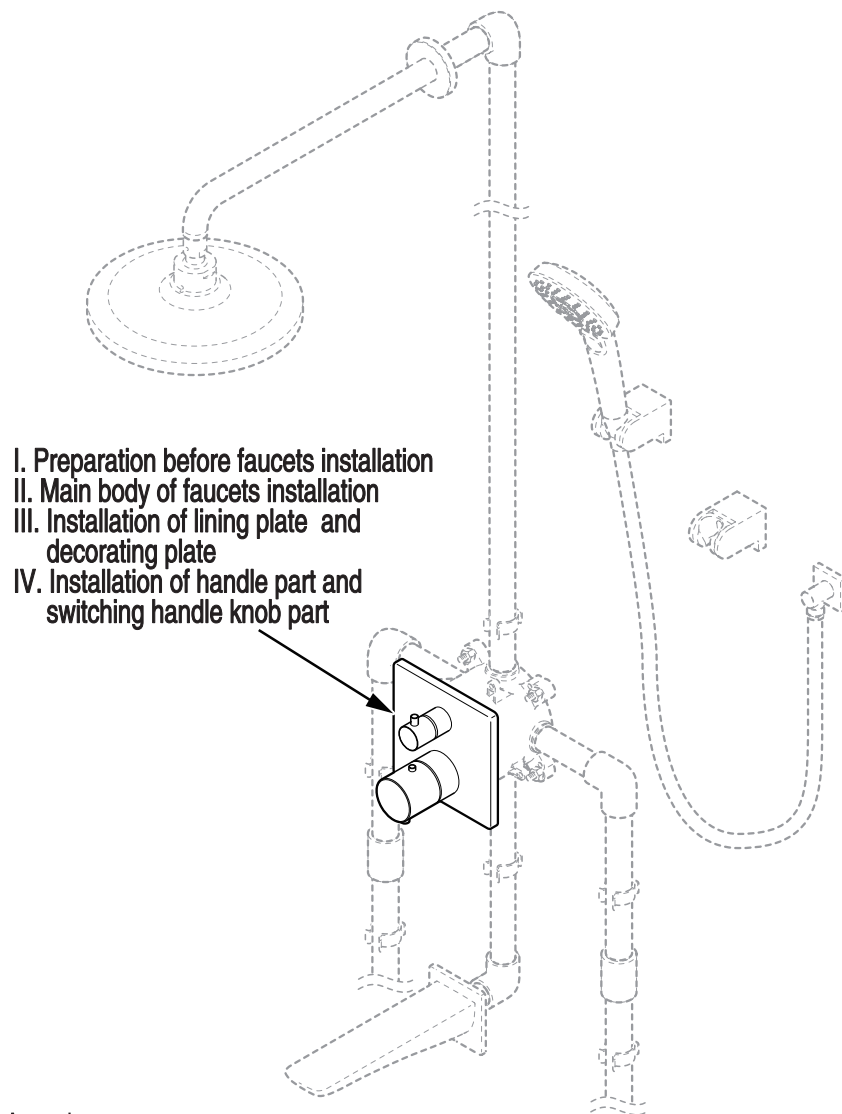

⚠ Attention:

Take TBV02404* as an example for construction description. The installation principle is the same for different product examples.

Faucets installation

Tools to be prepared before installation

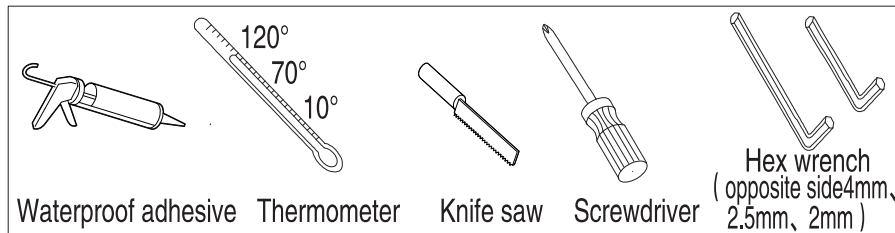

Confirmation before installation

■ Read the instructions for installation carefully and install according to the main points for installation therein.

I. Preparations before faucets installation

1. Use a knife saw to remove the part of MINI UNIT protruding from the wall surface. It is required to ensure that the convex edge of shell is within 2mm from the wall surface.

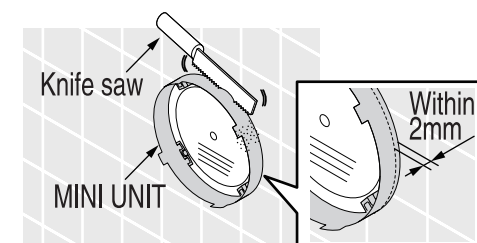

⚠ Attention

- In cutting MINI UNIT shell, pay attention to neat cut edge. (No edge will be recessed in the wall surface either).
- In cutting, the resin protective cover may be scratched. In this case, the use of the whole product is not influenced.

2. Apply waterproof adhesive uniformly in the gap between MINI UNIT and wall surface. No adhesive surface shall be convex from the wall surface.
 3. Remove the protective cover and then use a hex wrench to remove the washing cover.

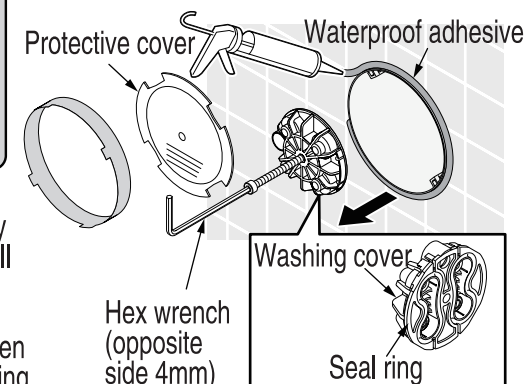

Faucets installation

II. Main body of faucets installation

1. Remove the main body of the faucets and remove the protective cover.
2. Note that the O-ring cannot fall off.
3. In installation, the "UP" on the main body of faucets faces upward. Use a hex wrench to fasten screws to fix the faucets.

Attentions

- When removing the protective cover, take care not to allow screws to drop and lose.
- Note that the O-ring cannot fall off.
- The screws for fixing the main body of faucets is fastened by using the hex wrench in the product package.
- The main body of faucets cannot be turned upside down in installation.

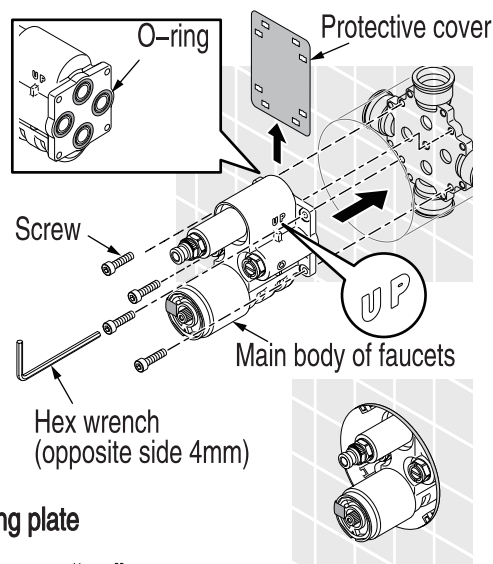

III. Installation of lining plate and decorating plate

1. Put in the main body of faucets according to the "UP" indication on the lining plate.
2. Use a screwdriver to fasten the screws on the lining plate.

Attentions

- Before installing the lining plate, make a pressure resistance inspection and confirm that both cold and hot water stop valves are opened completely.
- The lining plate direction cannot be turned upside down in installation, because the water discharge port is in the lower part.
- Do not use any sealant on the lining plate, because foam sealing strip exists on the lining plate and the water discharge port is located in the lower part.
- In fastening the screws, the lining plate must be compressed firmly and there is no gap between the lining plate and wall surface.
- The screws need to be screw tight manually. Do not use any electric wrench in fastening.

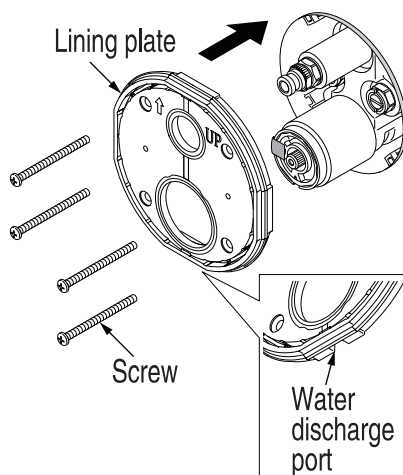

Faucets installation

3. Let the decorating plate pass through the cartridge sleeve cover with the water discharge port facing downward and put on the lining plate.
4. The decorating plate is kept within 1mm from the wall surface.

Attentions

- In installing the decorating plate, take care not to scratch the cartridge sleeve.
- Apply no waterproof adhesive around the decorating plate, because the water discharge port is located under the panel.

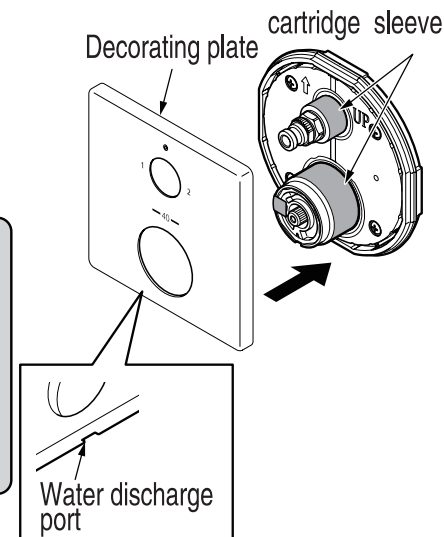

IV. Installation of handle part and switching handle knob part

1. After the handle rod is inserted into the connector in such a manner as facing upward, use a hex wrench (opposite side 2.5mm) to fasten the screws. Fix the handle.

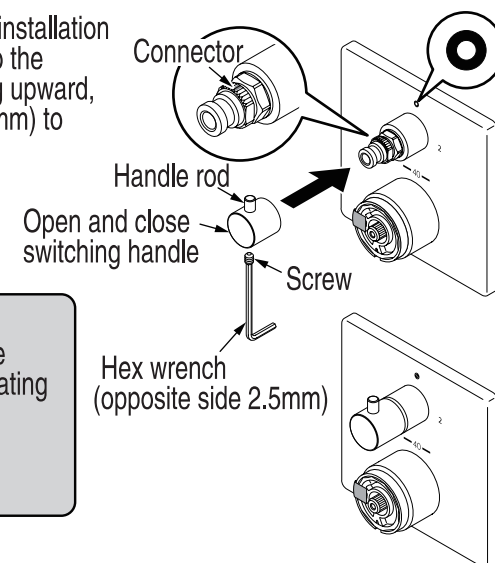

Attentions

- The handle rod is located at the position as indicated on the decorating plate.
- When leaving the factory, the cartridge is in a closed condition.

Faucets installation

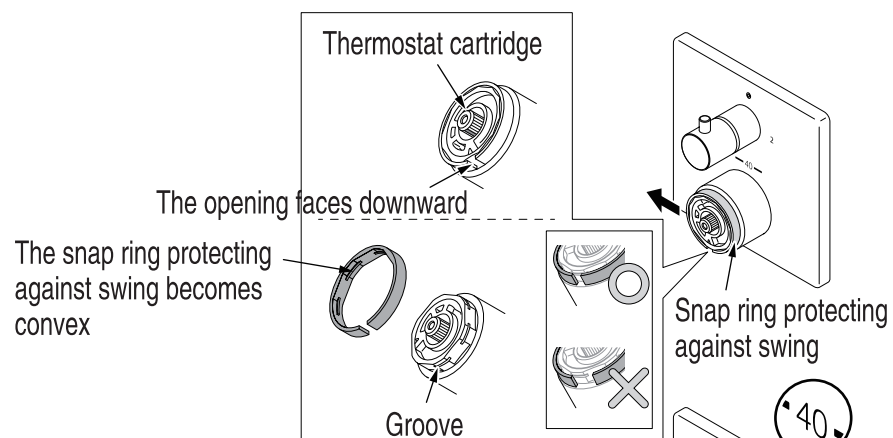

b. Installation of temperature-adjusting handle

1. Confirm that the snap ring protecting against swing does not fall off and the opening faces downward.
2. Put the handle onto the cartridge, the safety button and the "40" marking on the panel to be aligned in the center.
3. Fasten the screws with a screwdriver.
4. Put the handle cover on.

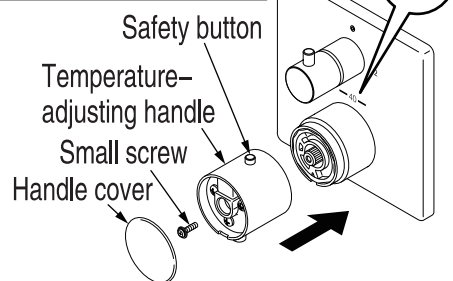

Attentions

- When leaving the factory, the water temperature of the faucets is set at 40°C.
- The snap ring protecting against swing becomes convex for press fit each other with the nut groove.
- Snap ring protecting against swing opening faces downward.

TOTO Asia Oceania Pte. Ltd.

Telephone: 65-6744-6955

FAX: 65-6841-0819

Address: 10 Eunos Road 8 #12-07 Singapore Post Centre
Singapore 408600

Website: asia.toto.com

TOTO KOREA LTD.

전화번호 : (02)-3141-8236

FAX 번호 : (02)-3141-8240

주소 : 서울시 마포구 토정로 112(상수동, 로이코빌딩 3층)

홈페이지 : <http://www.totokr.co.kr>