

施工说明书 Installation Manual

安装产品前请仔细阅读本施工说明书，并保留备用。
Before installing the product, please read the Installation
Manual carefully and keep it for future reference.

TOTO

TOTO



安装完成后，本说明书务必交由客户保存。
After installation, the manual must be kept by the customer.

0G272G(B)
2023.07

目录

目 录

目录.....	1
明细单.....	2
使用条件、施工上的注意与保养.....	3
安装完成图.....	4-7
淋浴支架的安装.....	8
生产厂家与销售商.....	9

TOTO Asia Oceania Pte. Ltd.

Telephone: 65-6744-6955

FAX: 65-6841-0819

Address: 10 Eunos Road 8 #12-07 Singapore Post Centre
Singapore 408600

Website: asia.toto.com

TOTO KOREA LTD.

전화번호 : (02)-3141-8236

FAX 번호 : (02)-3141-8240

주소 : 서울시 마포구 상수동 351-16번지 로이코빌딩 3층

홈페이지 : <https://kr.toto.com/>

Shower holder installation

1. As shown in figure 1, try to assemble the slide type shower holder. Install properly the fixed rod, slide seat, wall seat core, wall seat and decorating cover. (For specific assembly process, refer to step 3)

Attentions:

- ① Do not scratch the plated surface in installation or disassembly.
- ② Do not install reversely the slide seat. (The handle faces upward when the knob is locked)
- ③ The wall seat core is in the vertical direction.
- ④ The decorating cover with "TOTO" marking is installed on the wall in the lower part.

2. Drill a hole at a proper location on the wall against the type paper and drive the expansion sleeve into the hole.

3. At first, put the wall seat core through the wall seat and then fix the wall seat onto the wall with tapping screws; then put the decorating cover on the wall seat; fix the other wall seat properly by the same method; then insert the wall seat core head into the fixed rod installation hole. At last, tighten the straight fastening screws (Attention: ensure that the fastening screw head is inserted into the wall seat core); put the plug cover on properly to finish the product installation.

Attention: Please ensure the wall surface to be flat before installation; be sure to confirm the distance between the two wall seats. Ensure that the two wall seat cores coincide with the two installation holes for the fixed rod.

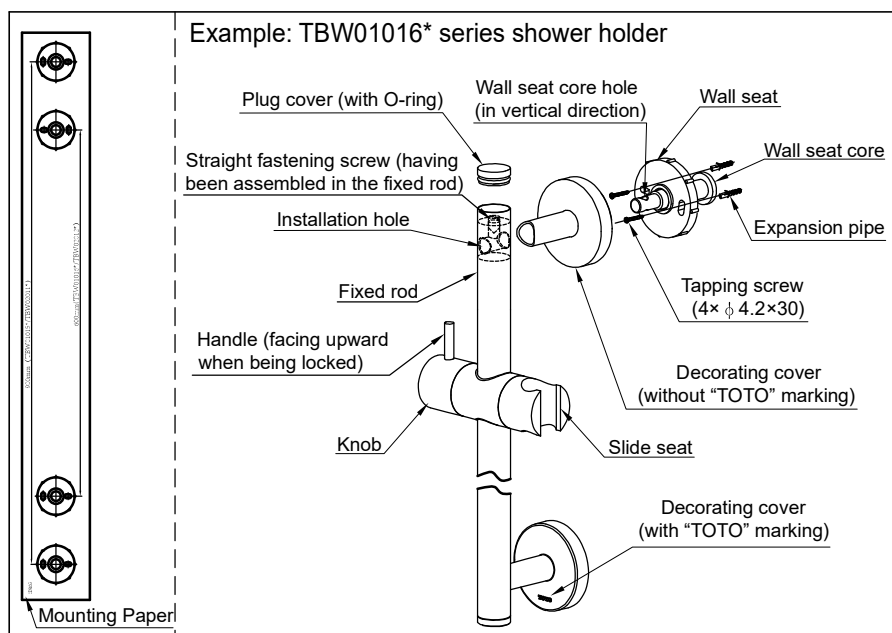

Figure 1: Shower holder installation

明细单

明细单

固定杆组品.....	1套
墙座+墙座芯+装饰盖.....	2套
塞盖.....	2套
零件包.....	1套
型纸.....	1张
施工说明书.....	1本
使用说明书.....	1本

使用此明细单的产品包括:

- TBW01015* 滑动式淋浴支架 (900mm圆型)
- TBW01016* 滑动式淋浴支架 (600mm圆型)
- TBW02011* 滑动式淋浴支架 (900mm方型)
- TBW02012* 滑动式淋浴支架 (600mm方型)

使用条件、施工上的注意与保养

使用条件

- 1.使用环境温度0℃以上。
- 2.如果您需要废弃本产品，请勿将其作为一般生活垃圾处理，请依照法规经由独立的回收体系进行合适的处理、恢复和回收。
- 3.本说明书的产品具有放置花洒及调节淋浴高度的功能。

施工上的注意

△注意 表示如果无视此标志而误操作时，有可能造成人身伤害或财产损失。

△注意

- 1.请勿撞击本产品，否则可能会造成故障。
- 2.请务必安装在混凝土墙面，必须使用本产品附带的膨胀管和自攻螺丝进行安装，否则因安装不稳定导致产品掉落下来可能会造成人员受伤。
- 3.安装结束后，请确认产品上是否有松动现象。产品有松动时，会造成产品脱落或墙面损坏而可能会导致使用者跌倒或受伤。
- 4.随着产品式样的不断更新，实物可能与图示不符，但基本原理相同。

保养

为长期保持产品的美观，请用户按以下方法维护保养。

- 1.经常用软布擦拭或用软布蘸水擦拭。
- 2.当有污垢且较明显时，请用中性洗涤剂擦拭后充分进行水洗。
- 3.不得使用洁厕粉、去污粉、机油、辛那水、强酸、强碱性洗涤剂或含颗粒物质的洗涤剂、尼龙刷子来清洁本产品。

Installation completion figure

TBW02012*

"L Shower" Sliding Rail 600 (Contemporary Type)

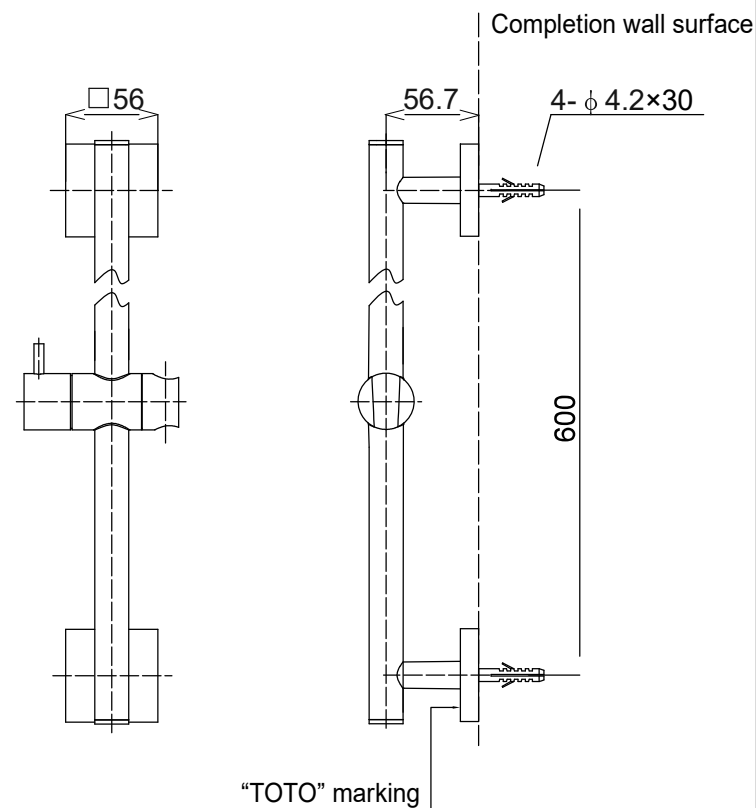

Note: The above dimensional unit is mm.

Installation completion figure

TBW02011*

"L Shower" Sliding Rail 900 (Contemporary Type)

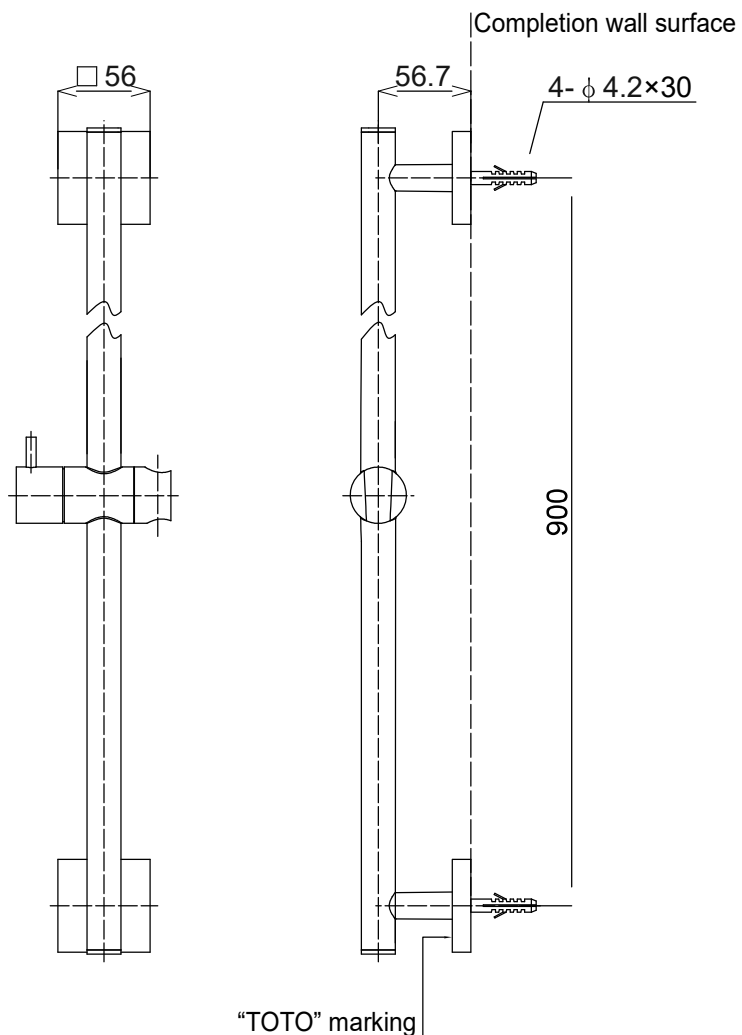

Note: The above dimensional unit is mm.

安装完成图

TBW01015*系列

滑动式淋浴支架 (900mm圆型)

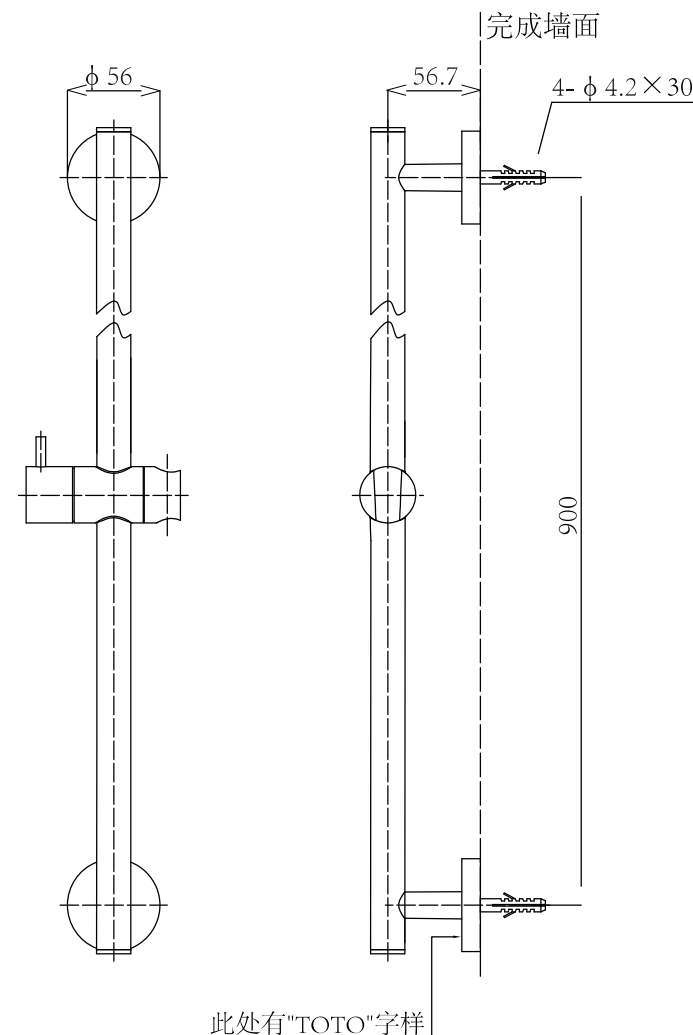

注：上記尺寸单位为mm；

安装完成图

TBW01016*系列
滑动式淋浴支架 (600mm圆型)

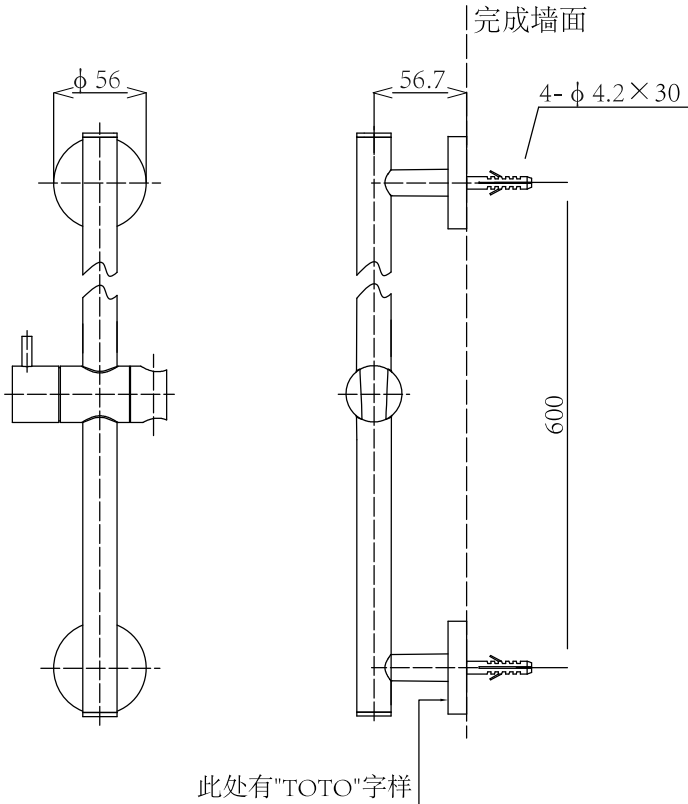

注： 上记尺寸单位为mm；

Installation completion figure

TBW01016*
"L Shower" Sliding Rail 600 (Standard Type)

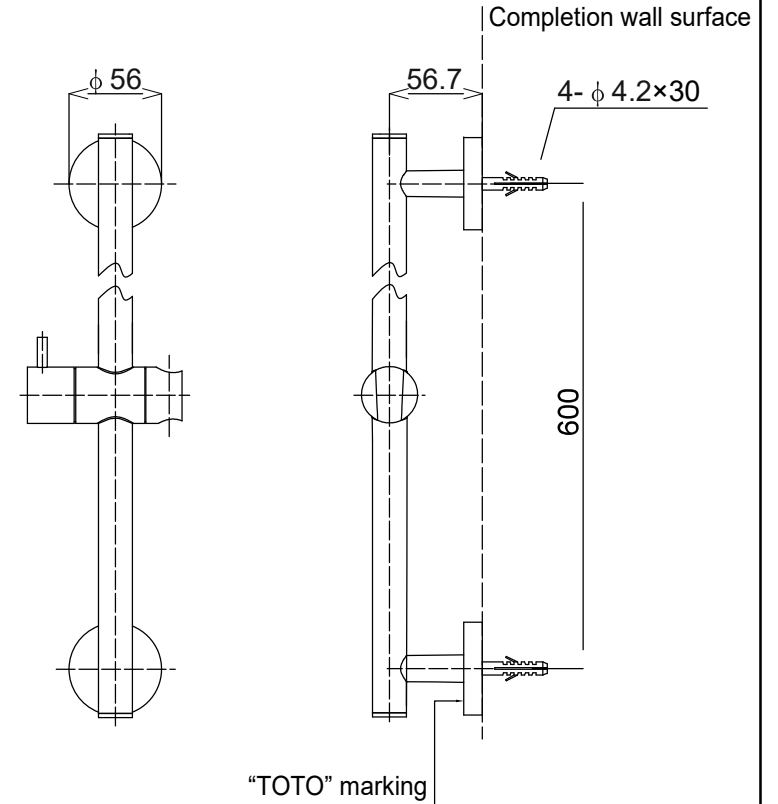

Note: The above dimensional unit is mm.

Installation completion figure

TBW01015*
"L Shower" Sliding Rail 900 (Standard Type)

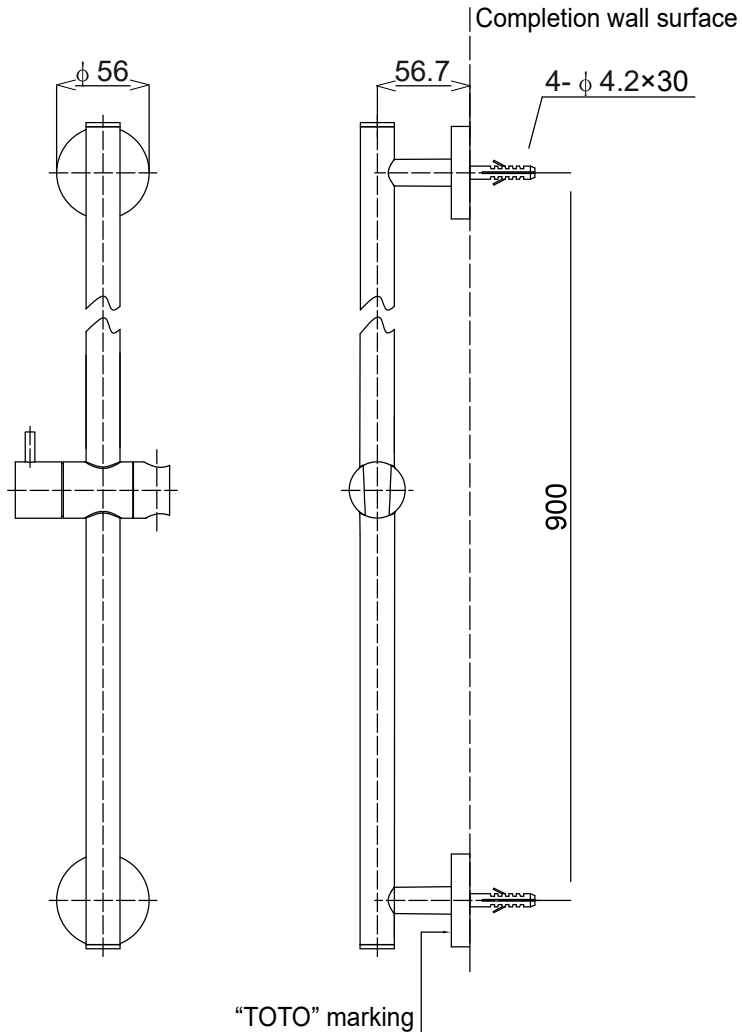

Note: The above dimensional unit is mm.

安装完成图

TBW02011*系列
滑动式淋浴支架 (900mm方型)

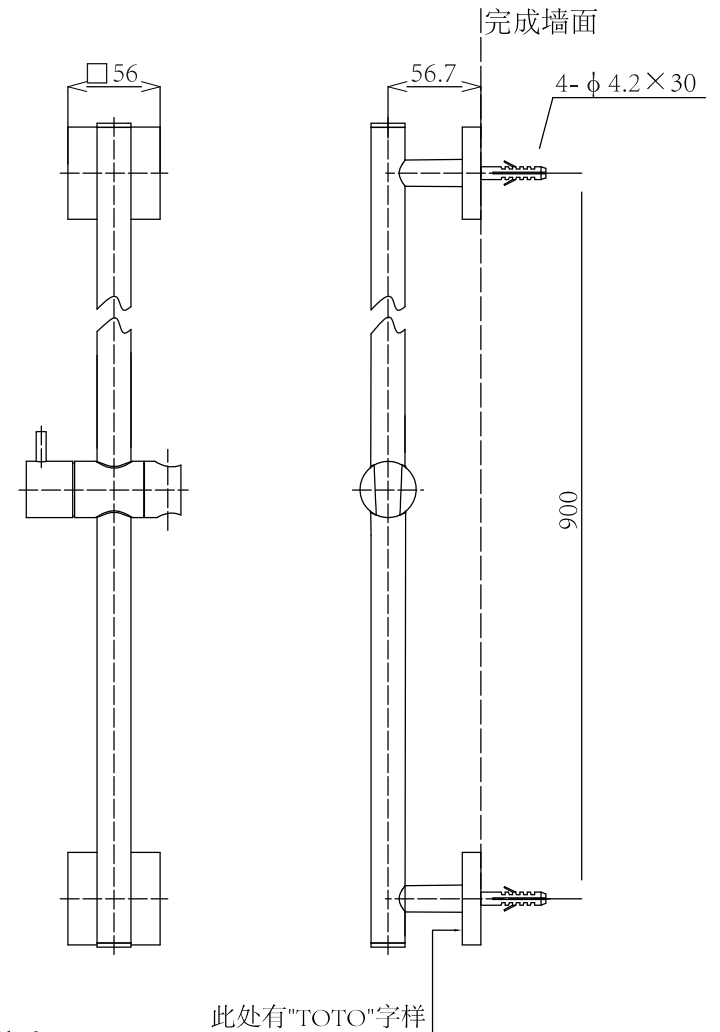

注：上記尺寸单位为mm；

安装完成图

TBW02012*系列
滑动式淋浴支架 (600mm方型)

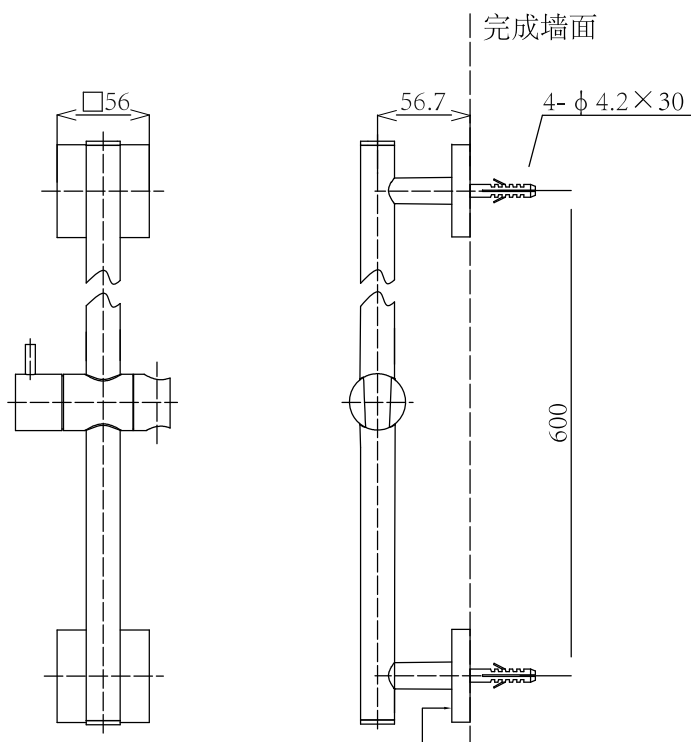

此处有“TOTO”字样

注：上記尺寸单位为mm；

Use condition, attentions in construction and maintenance

Use condition

1. The ambient temperature for service is above 0°C.
2. If you want to scrap this product, please do not dispose it as general living garbage. Please let an independent recovery system dispose, restore and recover in accordance with relevant statutes.
3. The product in the present instructions has the function to place a shower and adjust the bath height.

Attentions in construction

⚠ Attention: it means that ignoring this mark and misoperation may cause personal injury or property loss.

⚠ Attentions

1. Do not impact the product. Otherwise, failure, water leakage may occur.
2. Please be sure to install on the concrete wall surface. It is imperative to use the expansion pipe and tapping screws supplied with the product for installation. Otherwise, personal injury may occur due to product dropping as a result of instable installation.
3. After installation, please confirm if the product becomes loose. If so, the product may fall off or the wall surface damage may result in user falling or being injured.
4. With the product design being updated constantly, the physical object may not coincide with the figure. However, the basic principle for installation, use is the same.

Maintenance

To maintain a beautiful appearance of the product, the user is requested to conduct maintenance and care in the following method.

1. Wipe with a piece of soft cloth frequently and use a piece of soft cloth dipped in water to wipe from time to time.
2. When dirt exists obviously, please use water to wash sufficiently after wiping with a neutral detergent.
3. Do not use toilet cleaning powder, abstergent, machine oil, xina water, strong acidic and alkaline detergent or such detergent as containing particle matters, nylon brush to clean this product.

Detailed list

Detailed list	
Fixed rod assembly.....	1 set
Wall seat + wall seat core + decorating cover.....	2 sets
Plug cover.....	2 sets
Part package.....	1 set
Type paper.....	1 sheet
Instructions for construction.....	1 copy
Instructions for operation.....	1 copy
<p>The products using this detailed list include:</p> <p>TBW01015* "L Shower" Sliding Rail 900 (Standard Type)</p> <p>TBW01016* "L Shower" Sliding Rail 600 (Standard Type)</p> <p>TBW02011* "L Shower" Sliding Rail 900 (Contemporary Type)</p> <p>TBW02012* "L Shower" Sliding Rail 600 (Contemporary Type)</p>	

淋浴支架的安装

1.如图1，将滑动式淋浴支架试组装起来，安装好固定杆、滑动座、墙座芯、墙座、装饰盖。(具体的组装过程可参照步骤3)

注意：

- ①安装或拆卸时不要划伤电镀表面。
- ②滑动座不可装反。(旋钮紧锁时手柄朝上)
- ③墙座芯孔要在竖直方向上。
- ④带"TOTO"字样的装饰盖要安装在下面的墙座上。

2.比照型纸，在墙上选择合适位置打孔，将胀套打入孔内。

3.首先把墙座芯穿过墙座后用自攻螺丝将墙座固定在墙上；再把装饰盖套在墙座上；用同样的方法把另一墙座固定好；然后把墙座芯头部插入到固定杆的安装孔中，最后拧紧一字顶丝(注意：顶丝头一定要确保其插入到墙座芯孔中)；套好塞盖，完成产品的安装。

注意：安装前请确保墙面平整；务必仔细确认好两墙座间的距离，保证两墙座芯与固定杆的两安装孔相吻合。



图1：淋浴支架的安装

生产厂家与销售商

产品型号：见包装箱上的标签

产品名称：见包装箱上的标签

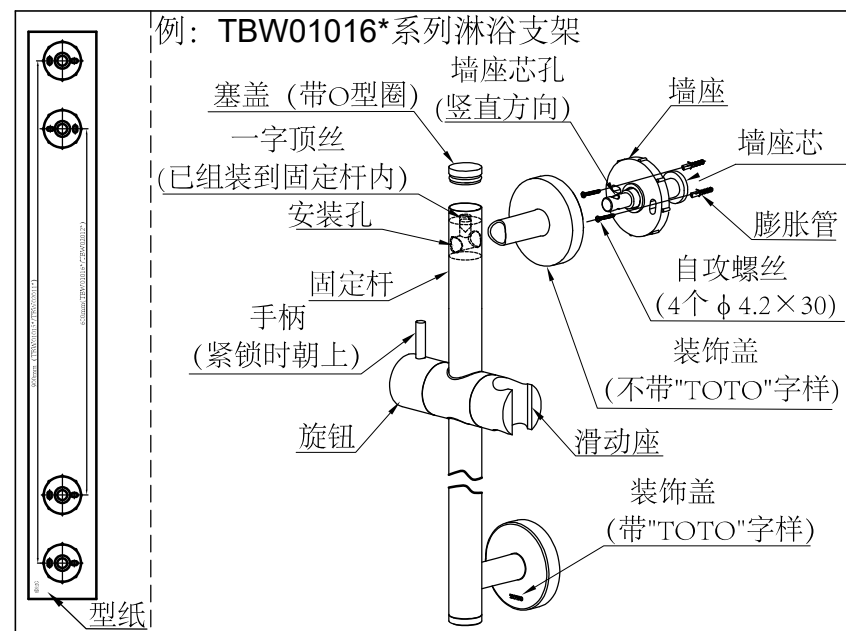
生产日期：见包装箱上的标签

组装工厂：东陶机器(广州)有限公司

厂址：广州市番禺区南村镇兴南大道715号

东陶(中国)有限公司

全国售后服务电话：800-820-9787(固定电话)

400-820-9787(手机用户)



扫描二维码，
服务预约，方便快捷

销售商：东陶(中国)有限公司

地址：北京市朝阳区光华路1号 北京嘉里中心北楼1915室

网址：www.toto.com.cn

Contents

Contents

Contents.....	1
Detailed list.....	2
Use condition, attentions in construction and maintenance.....	3
Installation completion figu.....	4-7
Shower holder installation	8